

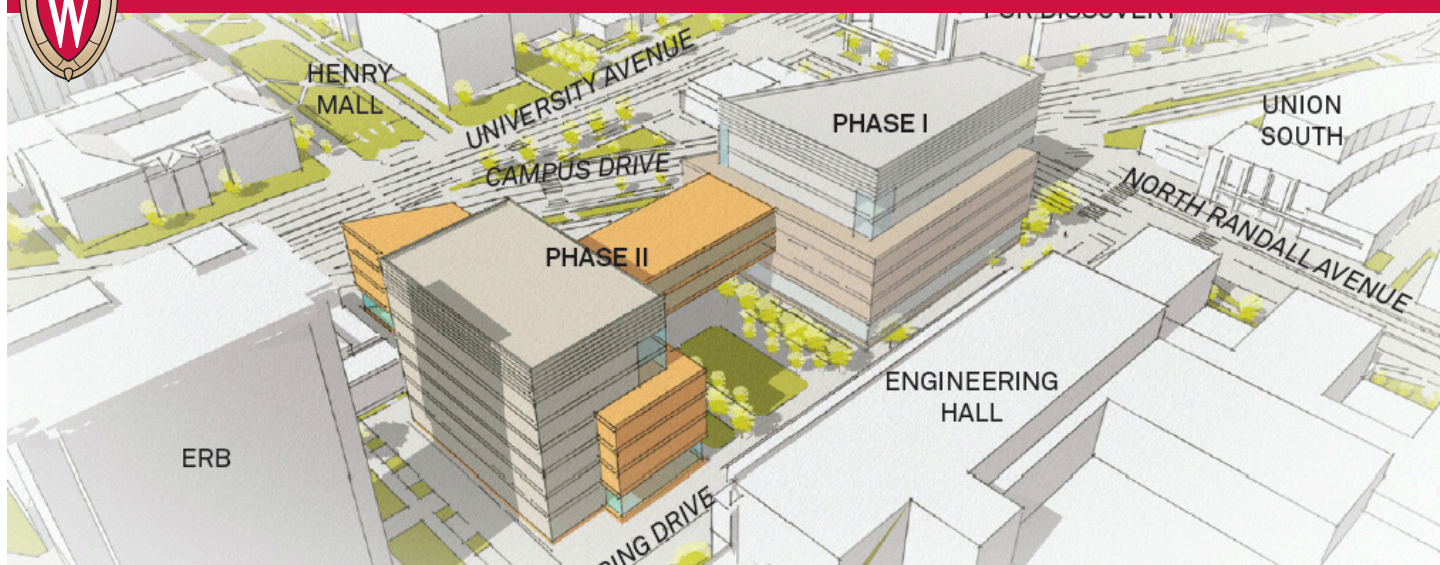

ENGINEERING BUILDING



EXPANDING ENGINEERING EDUCATION IN WISCONSIN

Background: The top-ranked UW-Madison College of Engineering is the second largest school/college on campus. Its 6,000 graduate and undergraduate students are the future engineering leaders of Wisconsin, with nearly 1,500 earning degrees last year.

UW-Madison engineering graduates are vital to the state's workforce and economic development needs, but we need more of them. Every year, many more students apply to be an engineering major than the College of Engineering has the capacity to accept. Expanding access to an engineering education begins by creating more space. A new, state-of-the-art building will provide the college the space to educate more engineering students and enable it to recruit and retain top-tier faculty members, sustaining our excellence in research and graduate education.

PROJECT OVERVIEW

Request: Build a new engineering building to support increased growth in the College of Engineering.

The Project

- Builds a state-of-the-art multidisciplinary educational facility to accommodate growth from 4,500 to 5,500 undergraduates.
- Creates flexible multi-disciplinary research space that enables us to expand into emerging research areas that could become important economic drivers.
- Increases our ability to recruit and retain top students and faculty.

2021-2023 Request: \$150M (\$100M GFSB; \$50M Gift/Grant). (Note that this is the first phase of a two-phase project with a total cost of \$300M (\$100M Gift/Grant; \$200M GFSB))

Learn More: budget.wisc.edu

UW-Madison Budget Contact: Crystal Potts, Director of State Relations | crystal.potts@wisc.edu @StateRelations 608-265-4105



ENGINEERING BUILDING

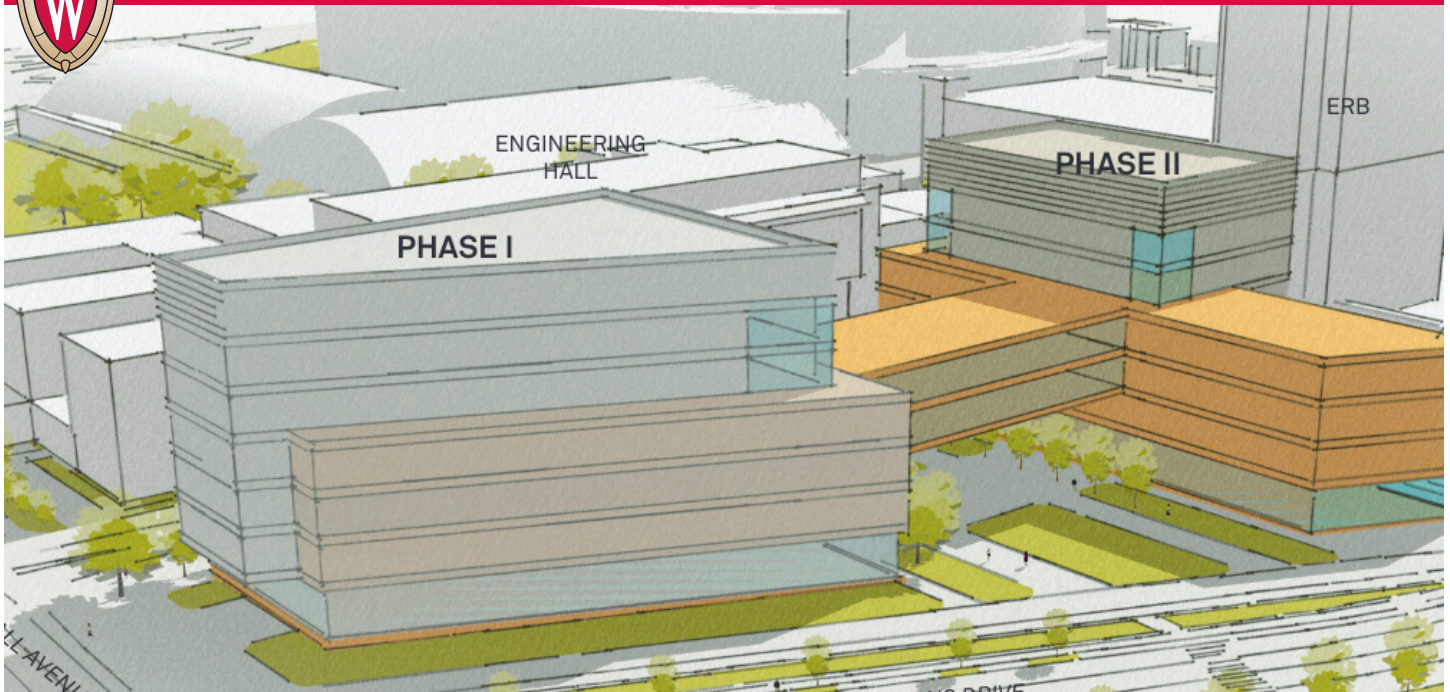

PROJECT NEED

The new building will help meet demands for engineering talent in Wisconsin and keep Wisconsin businesses competitive.

- Demand to obtain an engineering degree continues, with 1 in 6 UW-Madison students enrolling in engineering at the university.
- The majority of UW engineering students are from Wisconsin. After graduation, 70% stay and work in the Midwest.
- A larger building will create new space for students, with the plan to increase the undergraduate population by 1,000, helping to meet the demand from Wisconsin employers for more engineers.
- Engineering students have access to more than 12,000 job opportunities annually and many receive multiple job offers.

Creating a modern teaching and research facility is key to attracting top students, faculty and researchers.

- Engineering faculty, staff and students are at the forefront of research and innovation. They disclose more than 100 inventions each year, generate more than \$100 million in research expenditures and collaborate with hundreds of business partners across the state.
- Upgraded instructional and research facilities help attract and retain high-caliber faculty, staff, and students. This is key to generating research funding, educating tomorrow's engineering leaders, and enhancing the college's national reputation.

By supporting a new College of Engineering building, you'll help build the state's science, technology and engineering workforce, keeping Wisconsin companies competitive.

Learn More: budget.wisc.edu

UW-Madison Budget Contact: Crystal Potts, Director of State Relations | crystal.potts@wisc.edu @StateRelations 608-265-4105